

NOTE
 Cul-de-sac Closure.
 Access / Egress for emergency services and residents to be managed on site.

NOTE
 Traffic Management To Be Switched To Complete The Works

NOTE
 Pedestrians To Use Existing Dropped Kerbs

NOTE
 Pedestrian walkway to be installed on site if required. See pedestrian walkway detail for installation method.

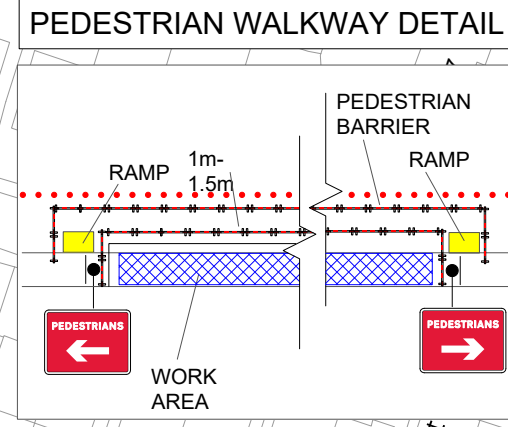

KEY

- Cone
- Sign
- Work area
- Diversion route
- Pedestrian diversion route

Sign Count 23

Diversion Route
 Clockwise Diversion

Shrawley Road / Broom Meadow Road / Dilmore Avenue

Anti-Clockwise Diversion

Dilmore Road / Broom Meadow Road / Shrawley Road

Min width of sideways safety zone (S) 0.5 m

Min length of longways clearance (L) 0.5 m

Speed of the road 30

Rev	Description	By	Chk	Date
Revisions				

Client:



Project:
 Westfield Road, Fernhill Heath,
 Worcestershire, WR3 7NN
 Grid Ref: (x)386488 ; (y)259120

Title:
 Road Closure & Diversion



Design: SH	Drawn: SH	Chkd: OP
Date: 09/12/25	Date: 09/12/25	Date: 09/12/25
Scale: A3 - NTS	Status: Proposed	

Drawing No Rev:
DTM8345 - 011