

Based upon the Ordnance Surveys map with the permission of the Controller of His Majesty's Stationery Office, Crown Copyright Reserved.  
 National Grid Electricity Distribution, Avonbank, Feeder Road, Bristol, BS2 0TB. License No. 100022432.  
 CARE SHOULD BE EXERCISED TO ENSURE THE PRECISE POSITION OF THE NGED APPARATUS IF WORK IS TO BE EXECUTED IN ITS VICINITY. If in doubt, contact your local NGED office.

Copyright: This copy has been made by or with the authority of National Grid Electricity Distribution pursuant to section 47 of the Copyright Designs and Patent Act 1988 unless that Act provides a relevant exception to copyright this must not be copied without the prior permission of the copyright owner.

Information is given as a guide only and its accuracy cannot be guaranteed.

PLEASE NOTE: This plan ONLY shows assets owned by National Grid Electricity Distribution (NGED). Electricity assets owned by National Grid Electricity Transmission (NGET) and IDNO's (Independent Network Operators) MAY be present in this area.

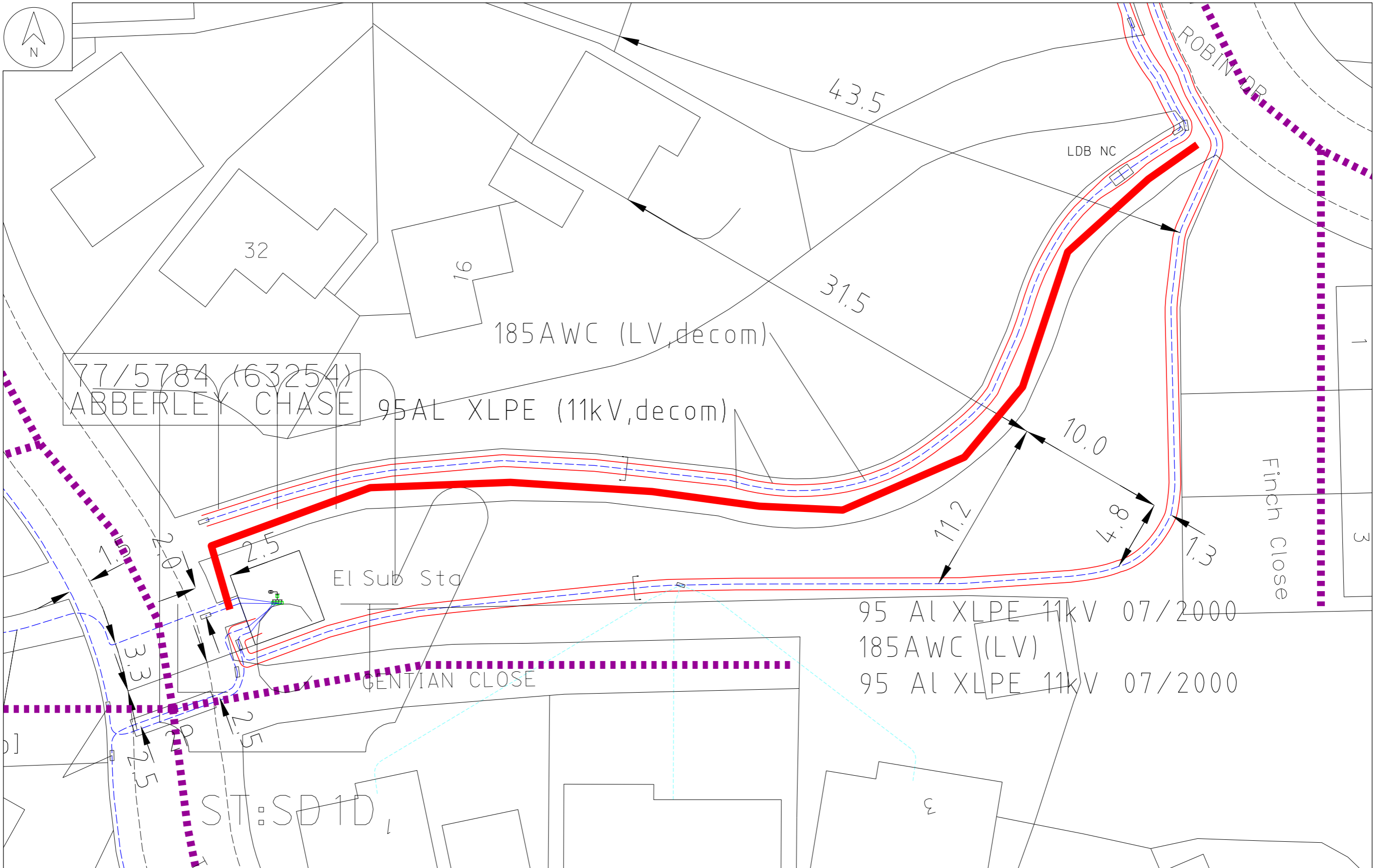

95 AL XLPE 11kV 07/2000  
 185AWC (LV)  
 95 AL XLPE 11kV 07/2000

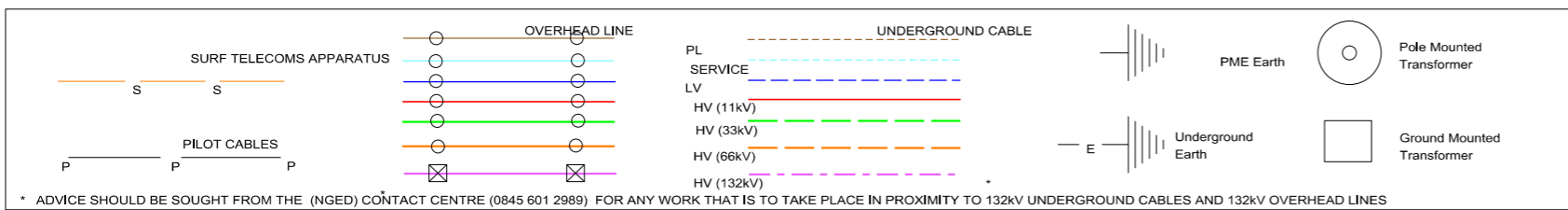

TITLE:  
 DRAWN BY:  
 DATE: 12/12/2025 @ A3  
 SCALE 1:250  
 PLOT CENTRE: 386140.908,259162.901



\* ADVICE SHOULD BE SOUGHT FROM THE (NGED) CONTACT CENTRE (0845 601 2989) FOR ANY WORK THAT IS TO TAKE PLACE IN PROXIMITY TO 132kV UNDERGROUND CABLES AND 132kV OVERHEAD LINES